

TAKING MEASUREMENT FOR YOUR KIT

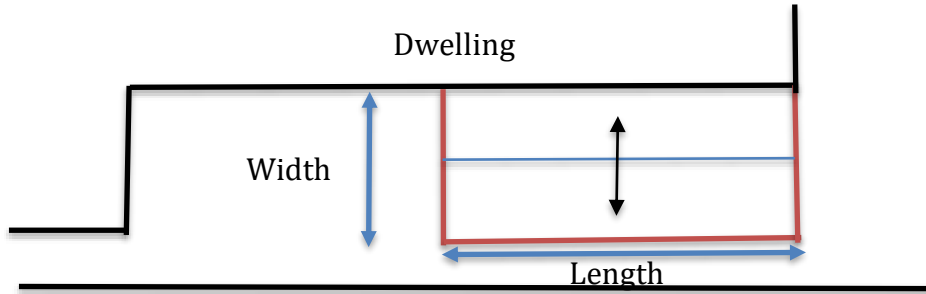

ATTACHED GABLE STRUCTURES

Instructions when your Verandah is to be attached to another existing structure. Normally this might be your home. If please so fill in below.



Width:

The width is what your Pergola (Verandah) will project from your dwelling. Gable structures are measured from outside to outside of both side beams

Firstly, what do you propose to attach to: Please tick your situation.

- 1. Fascia or
- 2. Wall

If Fascia, is your fascia made of metal or timber

- 1. Timber or
- 2. Metal

This measurement example assumes the ridge (center) will run along the length of the dwelling.

How to establish your width:

Measure from your wall to where project will finish the Deduct width of eave and gutter to calculate actual width of project.

If connecting to dwelling please advise the pitch of your existing dwelling (Home) roof) - 17.5°, 22° or 27° - circle your home pitch

Note: Kits come in 17.5°, 22° or 27° - please circle your choice of pitch

If attaching directly to a wall then just simply measure the width from the wall.

Width measurement Insert here: mm (ie 4300 mm)

Length:

Measure the length along the dwelling (which the verandah will fasten to). This will be same direction of the center ridge of structure will run

Length measurement Insert here:mm (ie: 7200 mm)

Note: All measurements taken outside of beam to outside of beam

Height:

Measure from the top of gutter to ground (or concrete) – check both ends of project length to establish (ensure) if height remains same. If different please advise both heights.

Height measurement Insert here: mm (ie: 2450 mm)

Ground surface:

Please advise what surface your project will sited above.

Your kit will be supplied to suit your ground situation.

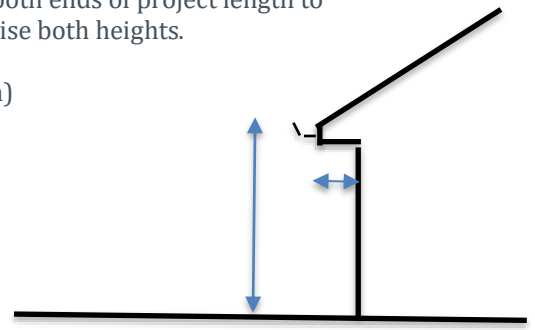

Note: different ground connectors are supplied dependent upon your ground surface.

Please tick what surface you have

- Concrete Surface: Decking Sub-floor In ground connection

IF CONCRETE CONNECTORS REQUIRED:

If connecting to concrete – bolt down stirrups are supplied for attachment to an existing suitable 100 mm concrete reinforced slab. It is important to ensure concrete is suitable for project. *(please seek qualified assistance to confirm acceptability)*

Note: Dyna bolts or other fastening options to concrete or a deck are not supplied with kits. Check Kit instructions for suitable connectors for your project.

POSTS IN-GROUND STIRRUPS:

If a pad footing is your project option ie: your stirrups are going to be concreted* into ground, then in-ground connectors will be supplied.

Note: Victory posts for in ground connection stirrups to provide increased ground contact durability. Our posts do not go directly into ground unlike other manufacturers due to the low durability of colorbond with direct contact to ground for long periods.

Note: Concrete is not supplied for stirrups. Check Kit instructions for pad footing size.

DECKING SUB-FLOOR:

Under some situation’s verandah post connection to a decking sub-floor is possible.

Our staff can discuss your situation if this required.

Note: Inspection by a qualified builder / practitioner should be considered to confirm concrete slab suitability prior to installation.

Dwelling Attachment:

All attached Victory DIY Kits assume that the project is coming from the fascia or wall of the dwelling. If proposed Kit to be connected from more than one side please advise us.

Please advise us if you’re coming from metal fascia, masonry wall or timber fascia as this can change attachments included in your kit.

Some variations can apply to attachment methods required so this information is important.

SITE CHECK MEASURE:

Outdoors Project Suppliers
52 Star Crescent Hallam Vic. 3803
Telephone: (BH) 03-97044900



Outdoor Project Suppliers experience staff can prior this service should you require a check measure. This is available in Melbourne metro area for an extra fee of \$350.00 – non-refundable and is extra to actual Kit purchase price.

ADVICE, PERMITS AND PREPARATION:

It is our wish that the purchase and installation of your DIY Kits is successful and a valued addition to your home. We advise you consider: -

- As there are Australian Standard Building requirements needed to be met, it is important that advice and assistance from suitability qualified builder / practitioner to review your site prior to building and ordering your Kit is undertaken and possibility during installation.
- A Building Permit is normally required for a roofed structure. You can confirm this via your local council or a registered building surveyor.
- All kits will come with project specific Engineering and a kit layout plan (of kit) that can be submitted along with your architectural plans to form part of your permit application. *Should any further information be required please contact our office?*
- If you wish to obtain a building permit prior to ordering your Kit, then a minimum 10% deposit is required from the cost of your total Kit purchase price to secure this engineering. *Check with your Drafting Consultant or Building Surveyor to ensure you can build in location proposed*

Note: All signed engineering plans are forwarded (emailed) upon initial deposit being paid, this will take 7 days from deposit payment.

Disclaimer and Notice:

Outdoor Project Suppliers has prepared this information sheet, and is general in nature, to assist with ensuring the success of your project installation. Please recheck your measurement prior to purchase as no responsibility is taken from incorrect measurements and instructions. No concrete, masonry or deck connections or stormwater products are included in kits.

If we provide an on-site inspection, then final measurement based on those site discussions, inspection and information provide by owner. It is Owner's responsibility to confirm measurements as to size, pitch, colours and location. Owner is to confirm written confirmation of these measurements and colours selected.

As DIY Kits installation remains the responsibility of owner / builder to provide measurement, attachment proposed & construct We cannot accept or take responsibility for incorrect installation, measurements or siting of a project.

We suggest consideration of a fully installed project by a qualified builder be considered. No storm water connection supplied beyond downpipes is standard to any kit supplied including concrete or masonry connections

All effort by Victory has been under taken to ensure Kits meet all Australian Building Standards and requirements. Refer to Victory web site for more Kit details and information brochures. www.victoryhomeimprovements.com.au